

ALL RIGHTS RESERVED

**NEW** WASTE-LESS TECHNOLOGY

## VERTICAL TYPE RUBBER INJECTION / TRANSFER MOLDING MACHINE

### APPLICATION

- Suitable for existing transfer molds, and hot runner injection molds.

### ADVANTAGES FOR RUNNING A TRANSFER MOLD ON THIS INJECTION MACHINE

- Material Saving - Saving rubber compound and leaving no transfer pad or flash.
- Labor Saving - No need to manually load and prepare the rubber blank or pad.
- An existing transfer mold can be adapted to this injection machine easily by making an additional cold runner injection plate

### ADVANTAGES FOR RUNNING A HOT RUNNER INJECTION MOLD ON THIS INJECTION MACHINE

- Accurate Material Dosing - Giving higher injection pressure for each mold cavity.
- Tool Cost Saving - No need to make new cold runner mold.
- Usage of Existing Mold - The existing hot runner mold can be adapted on this injection machine easily by removing the current hot runner and keeping the current injection points.

◆ NO WASTE!!

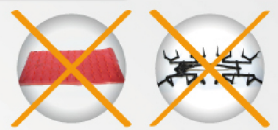

ALL RIGHTS RESERVED

## VERTICAL RUBBER INJECTION MOLDING MACHINE (F. I. F. O. - WITH SILICONE STUFFER)

### FEATURE:

- Easy to change colored rubber compounds and not waste rubber compound.

### F.I.F.O INJECTION SYSTEM

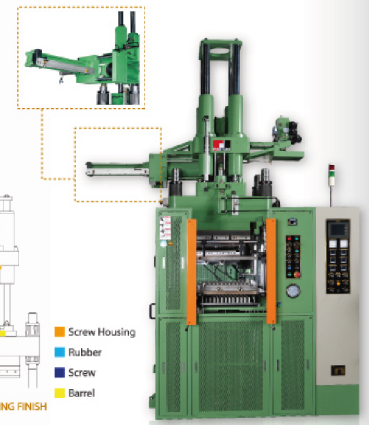
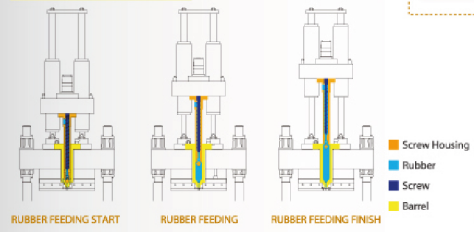

◆ WITH SILICONE STUFFER

## VERTICAL RUBBER INJECTION MOLDING MACHINE (F. I. L. O. - WITH SILICONE STUFFER) (WITH SILICONE STUFFER)

### F.I.L.O. INJECTION SYSTEM

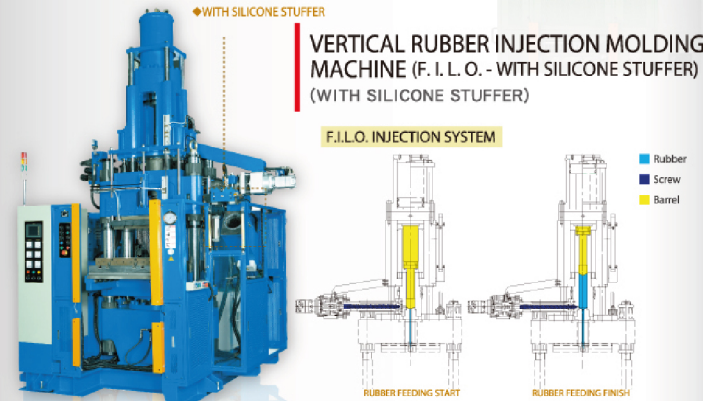

Your solution to producing high quality parts.



## RUBBER INJECTION MOLDING MACHINE SERIES

- VERTICAL RUBBER INJECTION MOLDING MACHINE
- HORIZONTAL RUBBER INJECTION MOLDING MACHINE
- C FRAME RUBBER INJECTION MOLDING MACHINE
- LIQUID SILICONE RUBBER INJECTION MOLDING MACHINE



# VERTICAL TYPE RUBBER INJECTION MOLDING MACHINE (F. I. F. O.)



## SYSTEM

- HOT RUNNER SYSTEM
- COLD RUNNER SYSTEM
- LOW-BED DESIGN
- HIGH-BED DESIGN

## FEATURE

- To avoid scorch rubber remaining inside barrel
- Easy to change rubber compound and not waste rubber
- Suitable for all kinds of rubber compound, silicone rubber and Viton.

## MODEL

Model **INJ** —  /  —  **RT—FIFO**

↓                      ↓                      ↓  
 ton                      c.c                      mold opening  
 clamping force      injection volume      system

## MACHINE SPECIFICATION

Clamping Force (ton)	Injection Volume (c.c)	Heating Platen size (mm)	Injection Pressure (kg/cm <sup>2</sup> )	Injection Temp. Control (sec)	Motor	Daylight (mm)	Stroke of Main Ram (mm)	Screw Diameter (mm)	Barrel Diameter (mm)	Screw Length / Diameter: L/D	OPTION
100	500 1000	405x430	1900	2	15HPx6P	350-450	350	φ 35 φ 40	φ 65 φ 80	1.5:1	1.Upper ejector (litw) 2.Bottom ejector (lifer) 3.Bottom mold is allowed to shuttle-out 70% for outside bottom ejector lifting up the final parts
200	1000/1500	550x550	1900	2	20HPx6P	400-550	450	φ 40	φ 80	1.5:1	4.2RT 5.3RT
250	2000/2500	650x650	1900	2	20HPx6P	400-550	450	φ 40	φ 80	1.5:1	6.Outside top and bottom ejectors
350	2500 3000	700x700	1900	2	25HPx6P	400-550	450	φ 40 φ 50	φ 80 φ 100	1.5:1	7.Middle mold turn 180-degree 8.Cold runner mold system 9.Watite-test technology 10.Silicone stuffer 11.For other mold open system, please refer to P.24
500	3000/4000	850x850	1900	2	25HPx6P	400-550	450	φ 50	φ 100	1.5:1	

## OPTIONAL

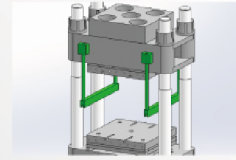

1. Internal upper ejector (Lifter)

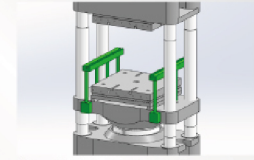

2. Internal bottom ejector (Lifter)

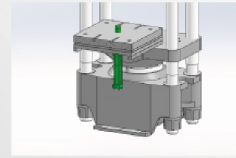

3. Bottom mold is allowed to shuttle out 70% for outside bottom ejector lifting up the final parts

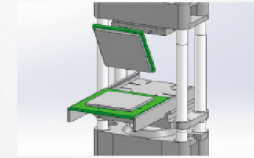

4. 2RT

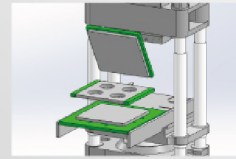

5. 3RT

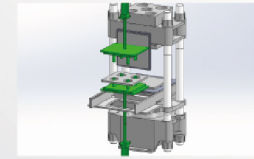

6. Outside top and bottom ejectors

## F.I.F.O. INJECTION SYSTEM

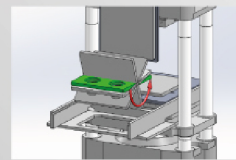
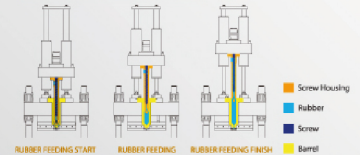

7. Middle mold turn 180 degree



ALL RIGHTS RESERVED

## VERTICAL RUBBER INJECTION MOLDING MACHINE

◆ Upper Ejector (lifter)



◆ Bottom Ejector (lifter)

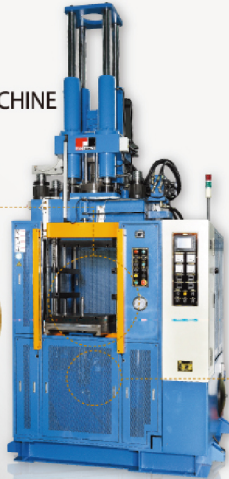

◆ Bottom mold is allowed to shuttle out 70% for outside bottom ejector lifting up the final parts

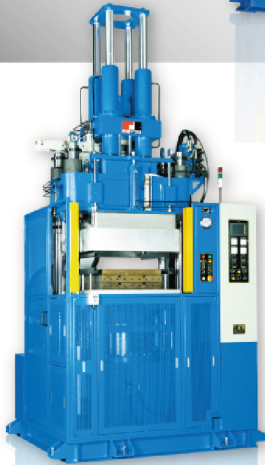

ALL RIGHTS RESERVED

## VERTICAL VACUUM RUBBER INJECTION MOLDING MACHINE (WITH TELESCOPED VACUUM CHAMBER)

■ **FEATURE:**

- To avoid scorch rubber remaining inside barrel
- Easy to change rubber compound
- Suitable for all kinds of rubber compounds

ALL RIGHTS RESERVED

## VERTICAL TYPE LOW BED RUBBER INJECTION MOLDING MACHINE

■ **FEATURE**

- LOW-BED Design to lower the working height.

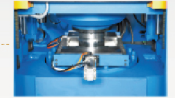
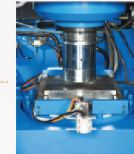
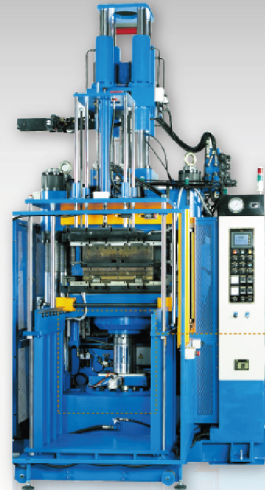

ALL RIGHTS RESERVED

## VERTICAL RUBBER INJECTION MOLDING MACHINE ( WITH HORIZONTAL INJECTION UNIT)

■ **FEATURE**

- To lower machine height
- With auto brush for deflashing





## C FRAME RUBBER INJECTION MOLDING MACHINE



### MODEL

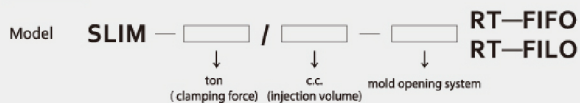

### MACHINE SPECIFICATION

	Clamping Force (ton)	Injection Volume (c.c.)	Heating Platen size(mm)	Injection Pressure (kg/cm <sup>2</sup> )	Injection Temp. Control (set)	Motor	Daylight (mm)	Stroke of Main Ram (mm)	Min. Mold Height (mm)	Screw Diameter (mm)	Barrel Diameter (mm)	Screw Length / Diameter: L/D	OPTION
F.I.F.O.	15	50	430x250	2100	1	5HPx4P	350	300	50	φ30	φ22.5	12:1	1.Upper ejector (lifter) 2.Bottom ejector (lifter) 3.Bottom mold is allowed to shuttle out 70% for outside bottom ejector lifting up the final parts
	30	100	400x300	2100	1	7.5HPx4P	350	300	50	φ30	φ30	12:1	
	50	200	450x300	2100	1	10HPx6P	350	300	50	φ30	φ40	12:1	
	80	250	450x350	2100	1	10HPx6P	350	300	50	φ30	φ40	12:1	
F.I.L.O.	15	50	430x250	1100	1	5HPx4P	350	300	50	φ30	φ22.5	12:1	
	30	100	400x300	1100	1	5HPx4P	350	300	50	φ30	φ30	12:1	
	50	200	450x300	1100	1	7.5HPx4P	350	300	50	φ30	φ40	12:1	

## C FRAME RUBBER INJECTION MOLDING MACHINE (F.I.F.O.)

### APPLICATION

- Oil seal and various rubber parts

### FEATURE:

- To avoid scorch rubber remaining inside barrel
- Easy to change rubber compound and no waste rubber
- Suitable for all kinds of rubber compound, silicone rubber and Viton

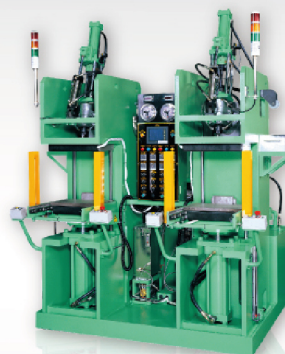
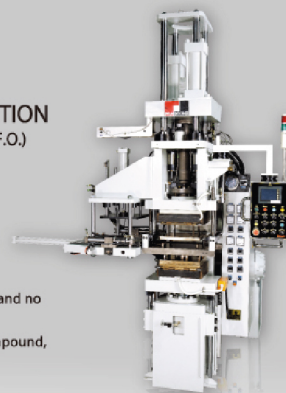

## C FRAME RUBBER INJECTION MOLDING MACHINE (F.I.L.O.)

### APPLICATION

- Corner jointing for automotive door strip and various rubber parts

### FEATURE

- Precise shot volume
- Fast and easy for mold change
- Easy operation



## HORIZONTAL RUBBER INJECTION MOLDING MACHINE (F. I. F. O.)

### MODEL

Model **HINJ** —   — **FIFO**  
 ↓  
 ton  
 (clamping force)

### MACHINE SPECIFICATION

Clamping Force (ton)	Injection Volume (cc)	Heating Platen size(mm)	Injection Pressure (kg/cm <sup>2</sup> )	Injection Valve Control (set)	Motor	Daylight (mm)	Stroke of Main Ram (mm)	Screw Diameter (mm)	Barrel Diameter (mm)	Screw Length / Diameter:LD	OPTION
50	100/160	300x450	1900	2	10HPx6P	450	350	φ35	φ65	1.5:1	1.Fixed face with hydraulic ejector (Iffar) 2.Mobile face with hydraulic ejector (Iffar) 3.Mobile face with central ejector 4.With brush System 5.Cold runner mold system 6.Silicone stuffer 7.Conveyor system
80	160/200	300x450	1900	2	10HPx6P	450	350	φ35	φ65	1.5:1	
100	200/400	405x430	1900	2	15HPx6P	450	350	φ35	φ65	1.5:1	
200	400/600	500x510	1900	2	20HPx6P	550	450	φ35	φ65	1.5:1	
250	600/1000	600x650	1900	2	20HPx6P	550	450	φ40	φ80	1.5:1	
350	1000/1500	650x700	1900	2	25HPx6P	550	450	φ40	φ80	1.5:1	
400	1500/2200	710x900	1900	2	25HPx6P	865	580	φ40	φ80	1.5:1	

### OPTIONAL

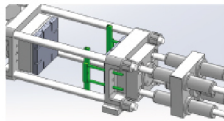

1.Fixed face with hydraulic ejector (Iffar)

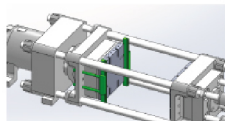

2.Mobile face with hydraulic ejector (Iffar)

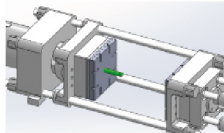

3.Mobile face with central ejector

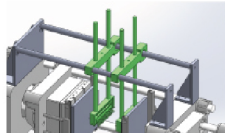

4.With brush system

ALL RIGHTS RESERVED

## HORIZONTAL RUBBER INJECTION MOLDING MACHINE (F. I. F. O.)



ASIAN CUSTOMERS' PREFERENCE

## HORIZONTAL RUBBER INJECTION MOLDING MACHINE (F. I. F. O.)

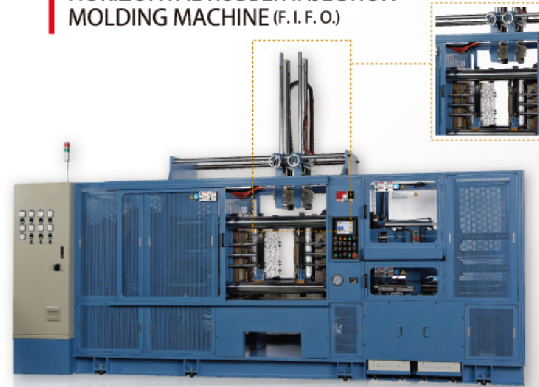

EUROPEAN CUSTOMERS' PREFERENCE

## LIQUID SILICONE RUBBER INJECTION MOLDING MACHINE



### MODEL

Model **LSR** —  /  — **FIFO**

↓                      ↓  
 ton                    c.c.  
 (clamping force) (injection volume)

### MACHINE SPECIFICATION

Clamping Force (ton)	Injection Volume (c.c.)	Heating Plates size(mm)	Injection Pressure (kg/cm <sup>2</sup> )	Motor	Daylight (mm)	Stroke of Main Ram (mm)	Screw Diameter (mm)	OPTION
100 / 200	200	400x400	700	11kw	500	400	φ 40	1. Liquid Silicone Mixing Device 2. For other Mold Open System, please refer to Page 24
200 / 250	400	500x500	700	11kw	500	400	φ 50	
250 / 350	800	600x600	700	15kw	500	400	φ 60	
		700x700						

## VERTICAL LIQUID SILICONE RUBBER INJECTION MOLDING MACHINE



## HORIZONTAL LIQUID SILICONE RUBBER INJECTION MOLDING MACHINE

